

# PERKINS POWER PRESSES

## MODEL C

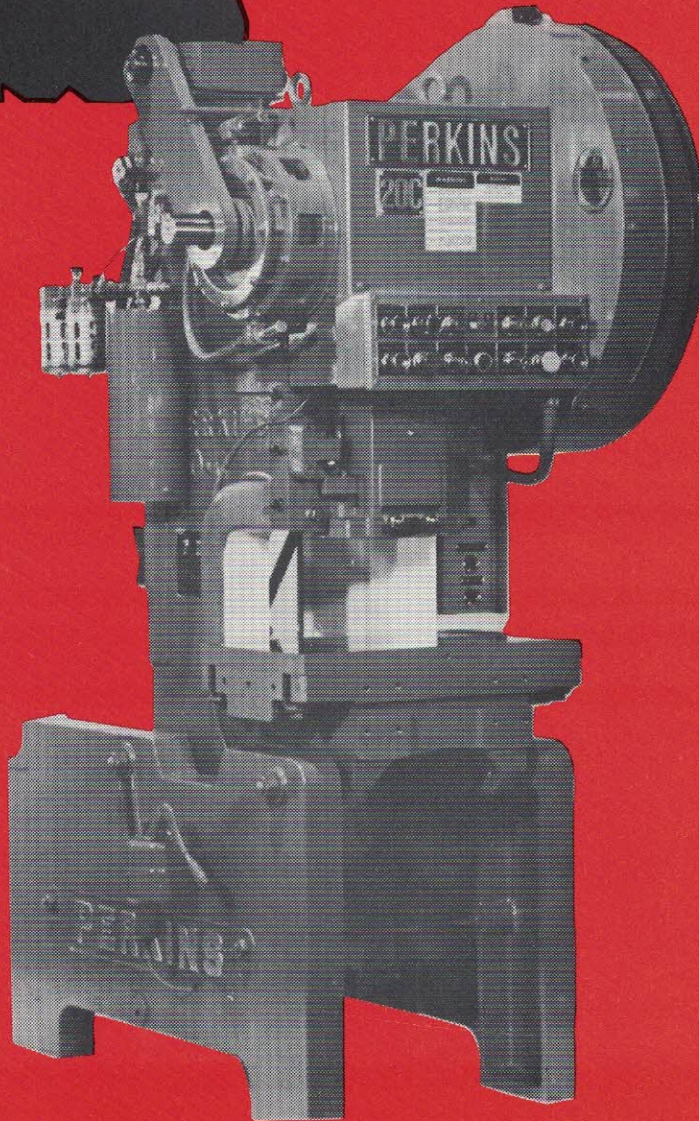

**PERKINS DIVISION**  
AUTOMATIC PRESS, INC.



117 DEAN AVENUE  
FRANKLIN, MA 02038



# PRESSES

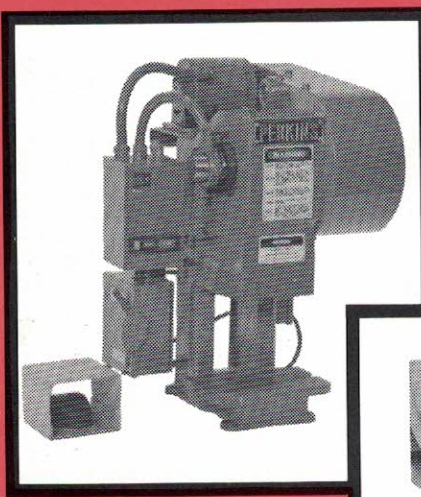

**3C BENCH PRESS**  
equipped with pin clutch  
and "K" trip with foot switch.

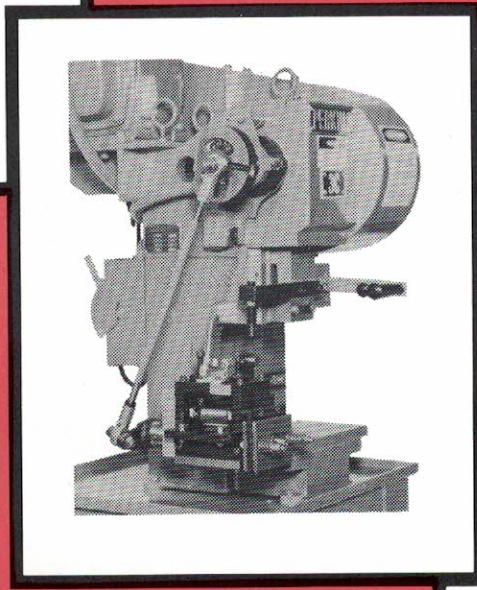

**3C PRESS WITH  
PIN CLUTCH**  
and single roll feed.  
(Feed cover removed  
to show details.)

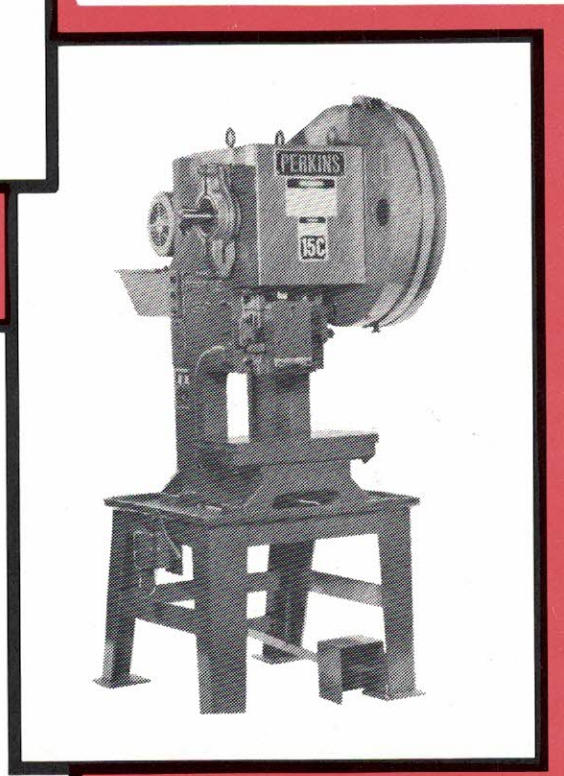

**15C PRESS**  
equipped with  
pin clutch and  
mounted on  
fixed base.

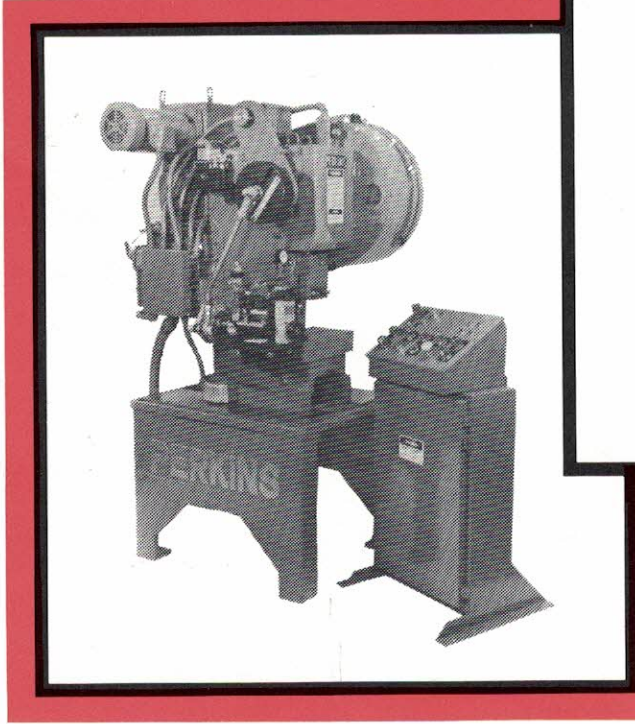



**10C PRESS**  
mounted on  
cast iron stand and  
equipped with single  
roll feed, air clutch  
and brake and console  
air clutch controls.  
(Feed cover removed  
to show details.)

**COVER PHOTO: 20C INCLINABLE PRESS** equipped with  
air clutch and brake.

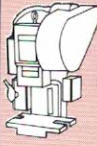
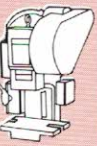
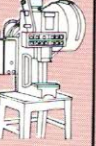

# SPECIFICATIONS

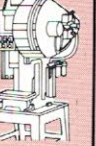
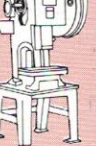
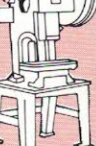
									
MODEL NO.		3C	3C	3C	5C	5C	10C	15C	20C
RATING	TONNAGE	3	3	3	5	5	10	15	20
	CRANKSHAFT DIA. MAIN & PIN	2 × 1	2 × 1	2 × 1	1 3/8 × 1 3/4	1 3/8 × 1 3/4	1 3/4 × 2 1/8	2 1/8 × 3	2 1/2 × 3 3/4
SLIDE	STROKE—STANDARD IN	1	1	1	1	1	1	1 1/2	2
	STROKE—MAXIMUM	1 1/4	3	3	3	3	4	4	4
	ADJUSTMENT OF SLIDE IN	1	1	1	1 1/2	1 1/2	1 1/2	2	2 1/2
DIE SPACE	DIST BACK FROM CENTER A	3	4	6	4	6	4 1/2 × 7 1/2	6 1/2	7 1/2
	THICKNESS OF BOLSTER PLATE	7/8	7/8	7/8	7/8	7/8	7/8	1 1/4	1 1/2
	OPEN HGT OVER BED SUAU B	5	6-8-10-12	6-8-10-12	8-10-12	8-10-12	8-10-12-14	9-12-15	9-12-15
BED	DIST FROM FLOOR TO BED	32	32	32	32	32	32	32	32
	WEIGHT LBS	200	225	250	600	650	1240	1700	2900
FLYWHEEL PRESS	STANDARD SPEED SPM	325	325	325	225	225	150	125	125
	MAX SPEED AIR CLUTCH SPM	ALNA	600	600	600	600	600+	425	400
	MOTOR HP—RPM	1/3-1800	1/3-1800	1/3-1800	1/2-1800	1/2-1800	1-1200	1 1/2-1200	2-1200
	GEARED PRESS	WEIGHT LBS	NA	255	280	665	715	1350	1800
	STANDARD SPEED SPM	NA	50	50	50	50	50	50	45

## SLIDE SPECIFICATIONS—MODEL C PRESSES

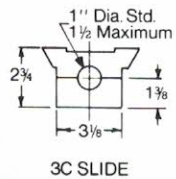

3C SLIDE

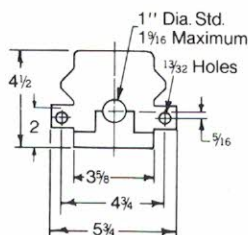

5C SLIDE

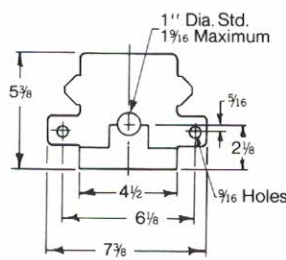

10C SLIDE

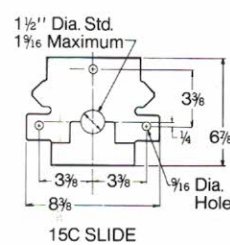

15C SLIDE

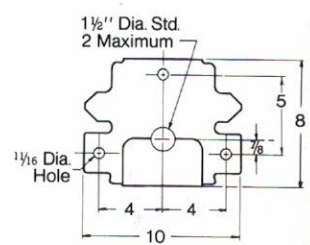

20C SLIDE

## BED AND FRAME

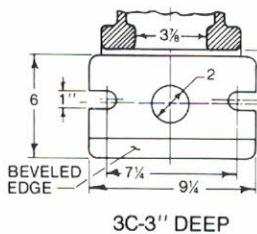

3C-3" DEEP

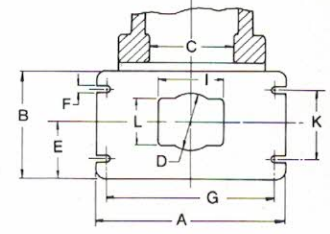
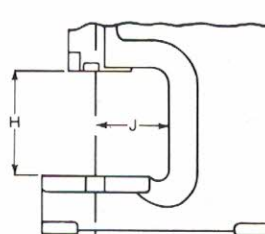
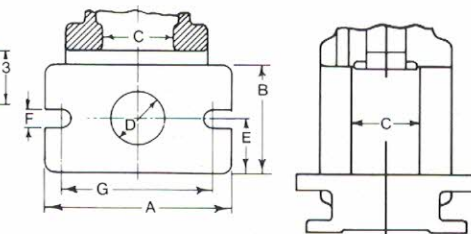

Model No.	A	B	C	D	E	F	G	H	I	J	K	L
3C	10 1/4	6	3 3/8	3	3	1	7 1/4	6-8-10-12	NA*	4	NA*	NA*
3C	12	6	3 3/8	3	3	1	10	6-8-10-12	NA*	6	NA*	NA*
5C	12	7 1/2	6	4	4	3/4	10	8-10-12	NA*	4	NA*	NA*
5C	12	8	6	4	4	3/4	10	8-10-12	NA*	6	NA*	NA*
10C	13 1/2	8	7	5	4 1/4	3/4	11 3/8	8-10-12-14	NA*	4 1/2	NA*	NA*
10C	13 1/2	8	7	5	4 1/4	3/4	11 3/8	8-10-12-14	NA*	7 1/2	NA*	NA*
15C	20	11 1/2	9	6	6	7/8	17 3/4	9-12-15	7	6 1/2	7 1/2	5
20C	24	13 3/4	11	9	7	1	21 3/4	9-12-15	10	7 1/2	10	7

\*NA = Not Applicable



## GENERAL FEATURES OF MODEL "C" PRESSES

### CLUTCH AND BRAKE:

Both a mechanical full revolution clutch and an air clutch and brake are available on the **MODEL "C" PRESSES**.

The **3C, 5C and 10C PRESSES** are equipped with combination air clutch and spring set brake. The **15C and 20C PRESSES** have separate air clutch and spring applied air released disc brake. Air clutch controls are manufactured to our interpretation of OSHA section 1910,217(b). Controls for hands in die operation are available.

### CRANKSHAFTS:

Crankshafts are made from alloy steel, turned from bar and ground to close tolerance.

### SLIDE & GIBS:

Ways are 90 degrees "V" and ground for accuracy. Connections are ball and socket with threaded adjustment for close ball seat clearance.

### FRAME:

Frames are one piece cast iron and are designed to minimize deflection and maintain accuracy.

### LUBRICATION:

Lubrication is provided by oil cup or optional one shot or automatic cyclic lubrication systems.

### AUTOMATIC FEEDING EQUIPMENT:

The **MODEL "C" PRESSES** can be equipped with many types of roll or dial feeds: mechanical, electronic or air feeds are available as well as cam driven and standard dial feeds. Please contact the factory with your specific requirements.

### OPTIONAL EQUIPMENT:

There are many different frame options available to provide the depth of throat and open height to suit your requirements.

Optional stroke lengths up to 4" are available depending on press size.

Other options include stands, inclining legs and attachments, crossbar knockouts, bolster plate (standard or special), non standard die shank hole, back gearing, bronze gibs, air c'balance, tool kits and work lights.

### DRIVE:

**MODEL "C" PRESSES** can be equipped with fixed or variable speed drives. Mechanical variable speed drives, eddy current drives and D.C. drives are available depending on your requirements.

Press speeds from 30 to 750 strokes per minute can be furnished. Please contact the factory with your requirements.

**PERKINS DIVISION**  
AUTOMATIC PRESS, INC.



117 Dean Avenue • Franklin, MA 02038  
Tel: 508-520-7219 • Fax: 508-520-7129